

Floor Plan

Scale: 4' per inch

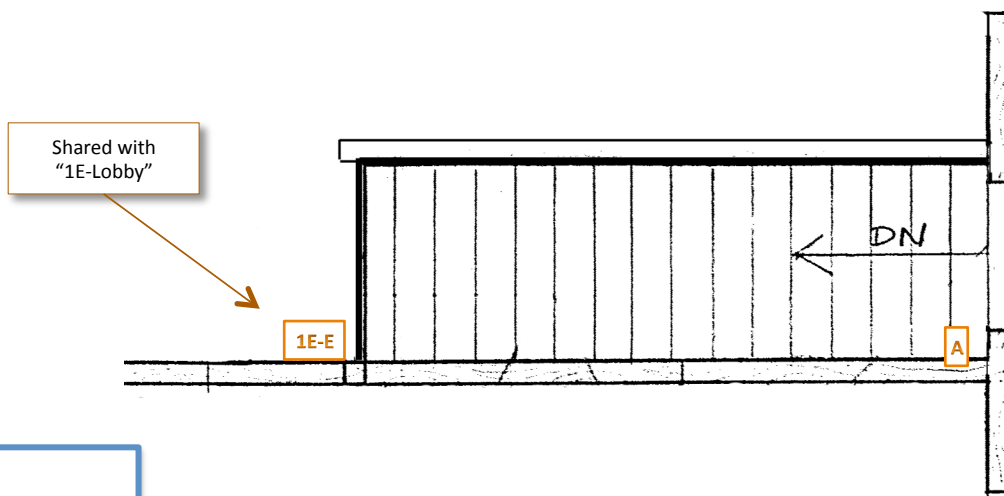

X = Switch Cluster

Lighting Controls

Scale: 4' per inch

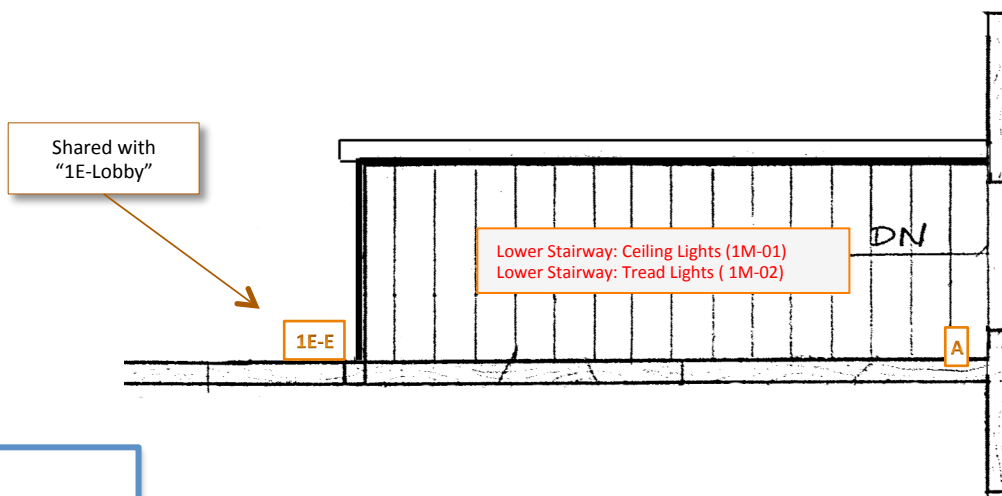

X = Switch Cluster

Scale: 4' per inch

## Keypad Location 1M-A Lower Stairs, East Wall



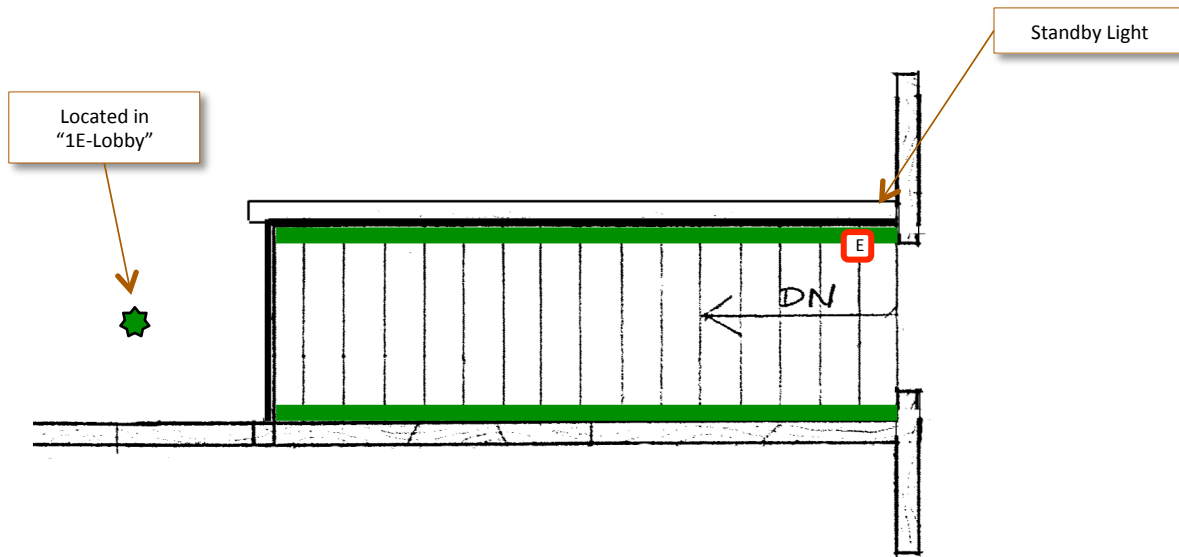

Lower Stairway: Ceiling Lights (1M-01)  
Lower Stairway: Tread Lights ( 1M-02)

Cables  
1 – White



Lighting 1

 = LV LED Ceiling Lighting  
(26' LED Tape) (1M-T01)

 = Standby Light

 = Surface Fixture (1M-01)

Scale: 4' per inch

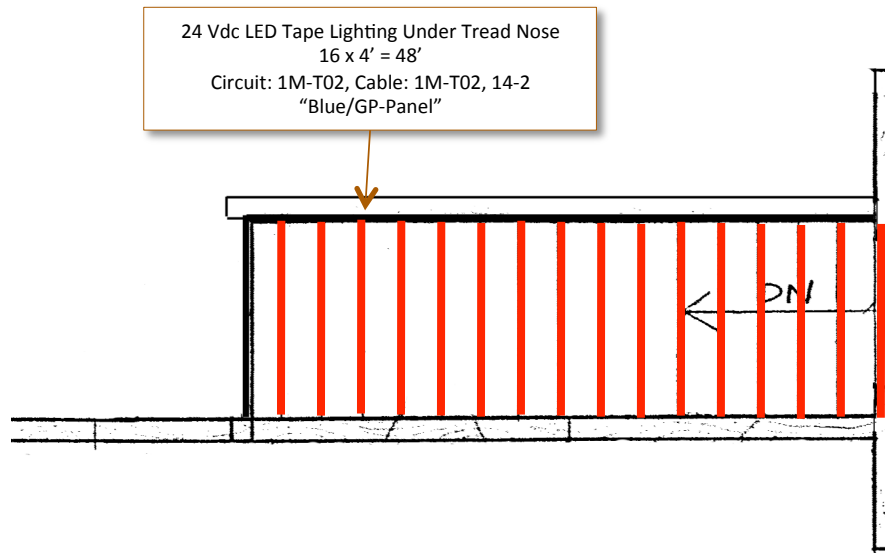

 = Tread LED Lighting (1M-02)  
Approx 48 lineal ft

Lighting 2

Scale: 4' per inch

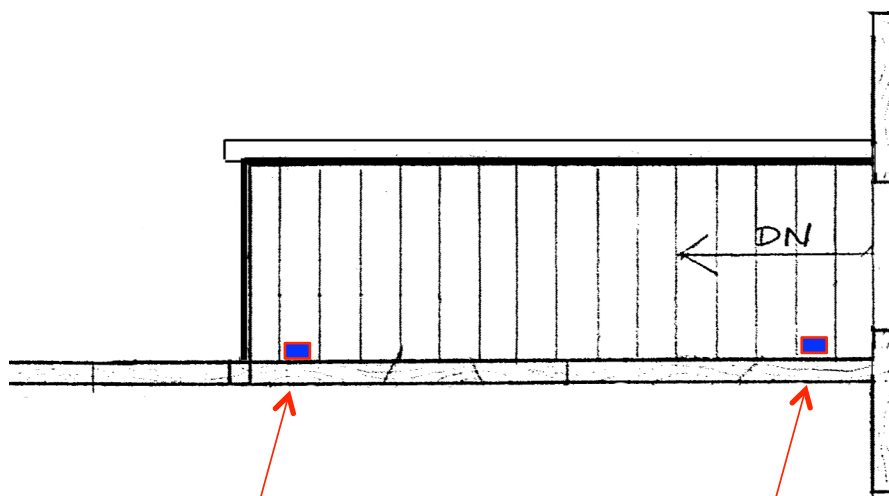

**Lower Stairway: Bottom Door Button**  
Circuit: 1M-A02, Cable 1M-A02  
Note: "Silver/CN-Panel", 22-6

**Lower Stairway: Top Door Button**  
Circuit: 1M-A01, Cable 1M-A01  
Note: "Silver/CN-Panel", 22-6

Systems

Scale: 4' per inch

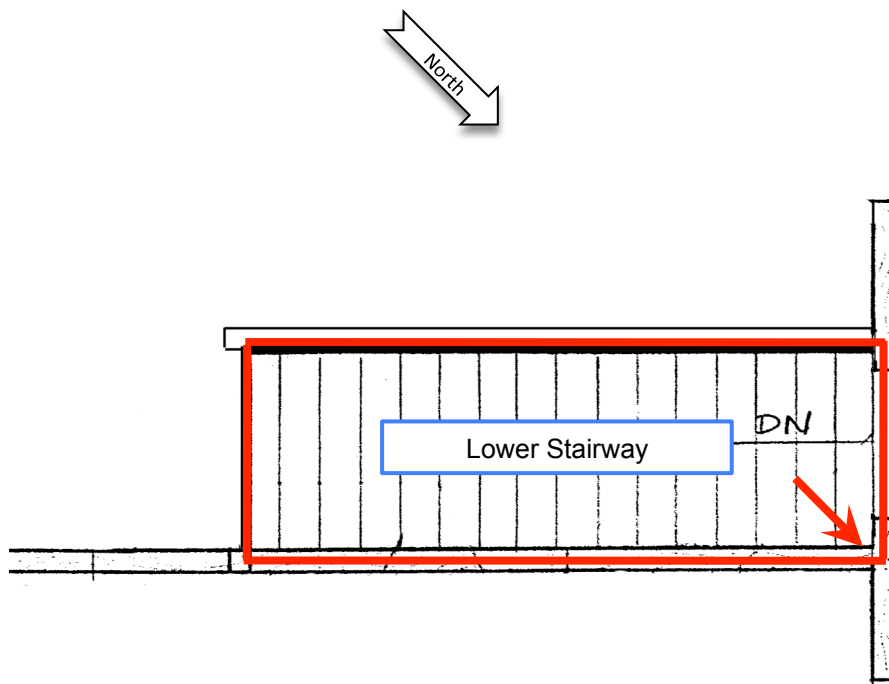

Region Overview

 = Region Boundary

 = Region Anchor Point (Corner)

Scale: 4' per inch